

## **Bind Off:**

**Written by Graciela Worth © August 20, 2007**

This bind off is a simple one.  
It works better if the last row is knit loosely.

It is work starting at the opposite end of the working yarn.

Move the stitch from the second peg, to the first peg, again remember we are talking opposite side of the yarn.

Now there are 2 loops on the first peg, knit 1 over 1 on the first peg.

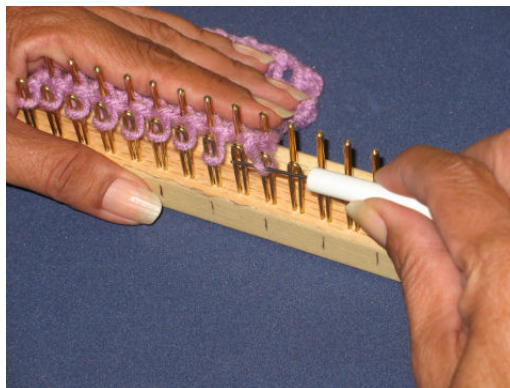
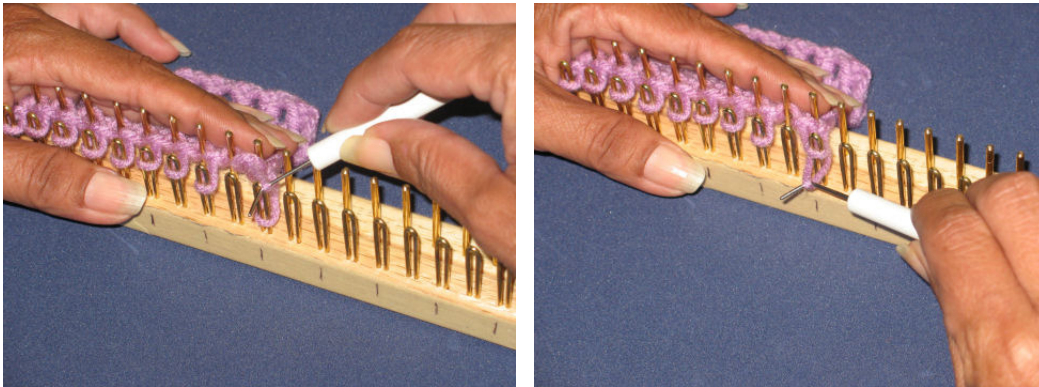

Repeat this process until you have only one loop on the peg, next to the working yarn, cut the yarn leaving a long tail, take the loop off the peg, and put the yarn thru the loop and pull. Lift the piece of the pins.

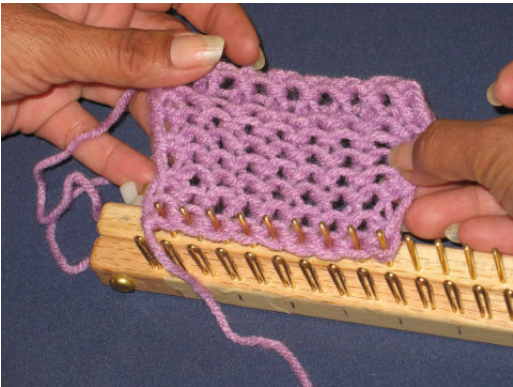
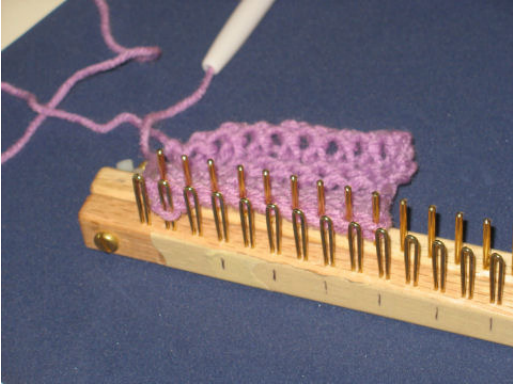

And lift off the loom!